

FORM No. 1.

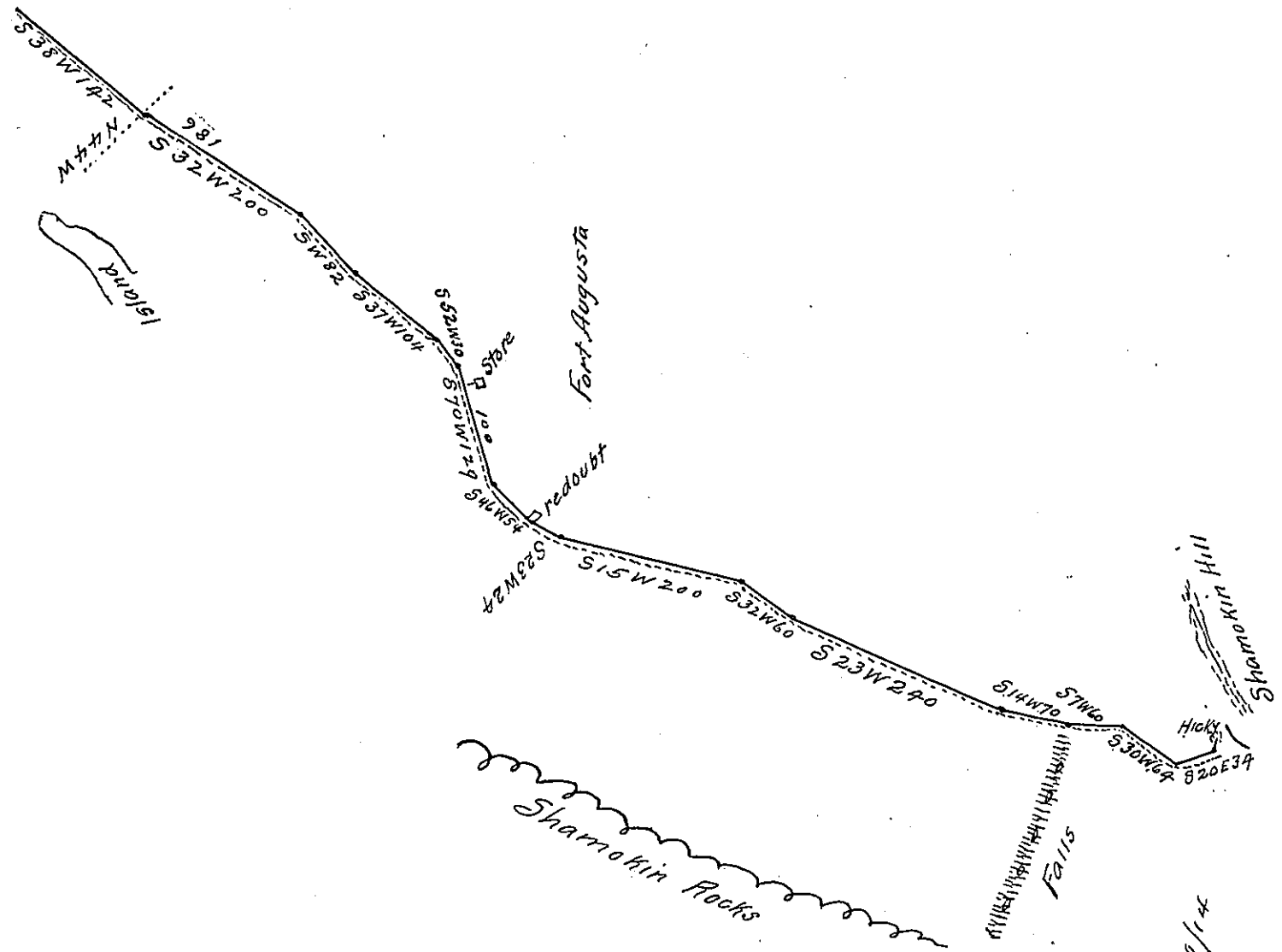

Beech Co East^{wd} of a Run

Courses from ye Beech to ye Stone

1 - W 68 / a 8 Rivers Mouth } 1 Thence S 10 E 280 p ^{5ml} ^{HICKY} a 18 run in a 120 run in a 240 Winding Path of the fort bears from said Path S 88 W

2 - S 39 W 30 -

3 - S 35 W 1 a 34 run - } 2 - N 80 E 644 p a 390 run in, a 594 run in

IN TESTIMONY that the above is a copy of the original remaining on file in the Department of Internal Affairs of Pennsylvania, made conformably to an Act of Assembly approved the 16th day of February, 1833, I have hereunto set my Hand and caused the Seal of said Department to be affixed at Harrisburg, this Twentieth day of April 1910

Nevy Howell
Secretary of Internal Affairs.